

<b>Modesta Real Estate s.r.o.</b>	CONTACT	<b>Ing. Peter Miscik</b>
Hviezdoslavovo namestie 7	EMAIL	miscik@modestagroup.com
811 02 Bratislava, Slovakia	TELEPHONE	+421 232 40 8888
www.modestagroup.com	MOBILE	+421 904 286 848

**OFFICES FOR RENT**

## OFFICE CENTRE JAROŠOVA, BRATISLAVA



ADDRESS	<b>Jarosova Street, 821 03, Bratislava</b>
SIZE	Offices from 60 to 4000 square meters currently available
KEY POINTS	<ul style="list-style-type: none"> <li>• Modern office space</li> <li>• Amenities and services nearby</li> <li>• Reception, elevator, 24/7 access to the building</li> <li>• Parking in front of the building and in garage</li> </ul>
LOCATION DESCRIPTION	12-storey administrative building Jarosova Office Centre is located in Bratislava District III near the Polus Shopping Centre and OD Slimák. Location allows for easy access by car and public transport. Short distance from the city centre and Bratislava District II.
PROPERTY DESCRIPTION	Modern office space of good quality standard. Air conditioning, openable windows, carpet floor. Entrance hall and reception, 24/7 access to the building, security service. Excellent civic amenities in the area. Parking spaces nearby the building and in an underground garage.
RENT	Upon Application

TEL: +421 2 32 40 88 88

[www.modestagroup.com](http://www.modestagroup.com)

<b>Modesta Real Estate s.r.o.</b>	CONTACT	<b>Ing. Peter Miscik</b>
Hviezdoslavovo namestie 7	EMAIL	miscik@modestagroup.com
811 02 Bratislava, Slovakia	TELEPHONE	+421 232 40 8888
www.modestagroup.com	MOBILE	+421 904 286 848

**OFFICES FOR RENT**

Location



Typical floor plan

**JAROSOVA - OFFICE BUILDING**  
office spaces  
alternative 4.

loggia - 1,4m2		A - office space - 304,8m2...29,7m2cs...4,05m2lo	38
		B - office space - 96,7m2...9,4m2cs...1,29m2lo	11
		C - office space - 130,3m2...12,7m2cs...1,73m2lo	15
		D - office space - 126,9m2...12,4m2cs...1,69m2lo	12
		E - office space - 95,4m2...9,3m2cs...1,27m2lo	6
		F - office space - 298,3m2...29,1m2cs...3,97m2lo	23
loggia - 1,4m2		common space - 102,6m2	
		vertical communications - 55,7m2	
		service room - 12,2m2	

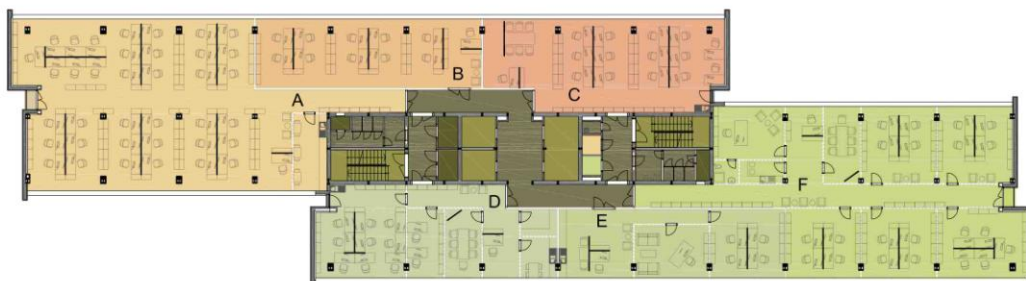

Further information available upon request

These particulars are a general outline only, for the guidance of prospective purchasers or tenants, and do not constitute the whole or any part of an offer or contract. Modesta will not be liable, in negligence or otherwise, for any loss arising from the use of these particulars.